

PUBLIC CONSULTATION

Proposed Wind Turbine on land at White Gap Road, Rowley, Little Weighton, East Riding of Yorkshire

THE SITE

Mr John Clappison is submitting a planning application for a single wind turbine (67m tip height) at Park Farm, land south of Common Road, Rowley, Little Weighton, HU20 3UN.

The Park farm holding is 584 acres of arable land, with the proposed turbine situated on 1.7 acres of land in total. The applicant's family have operated at Park Farm since 1932 and have grown operations into the largest producer of Brussel Sprouts in Yorkshire. The farm supplies 3 major UK supermarkets and many local pubs, restaurants and farm shops.

THE PROPOSAL

The proposed turbine will measure 67m (tip height) and be situated at Easting: 497610, Northing: 43428, south of an existing farm structure utilised for the grading, packing and storage of Brussel Sprouts.

The proposed turbine will have capacity to generate up to 1MW of energy, which will significantly reduce the farms carbon footprint and enhance onsite energy resilience.

Furthermore, with customers and supermarkets requesting carbon net-zero produce, the turbine will assist in the continued supply of local produce to Yorkshire supermarkets, thus ensuring the long-term sustainability of an existing farming business. A new access track, measuring 517m will be constructed from Common Road for installation and maintenance.

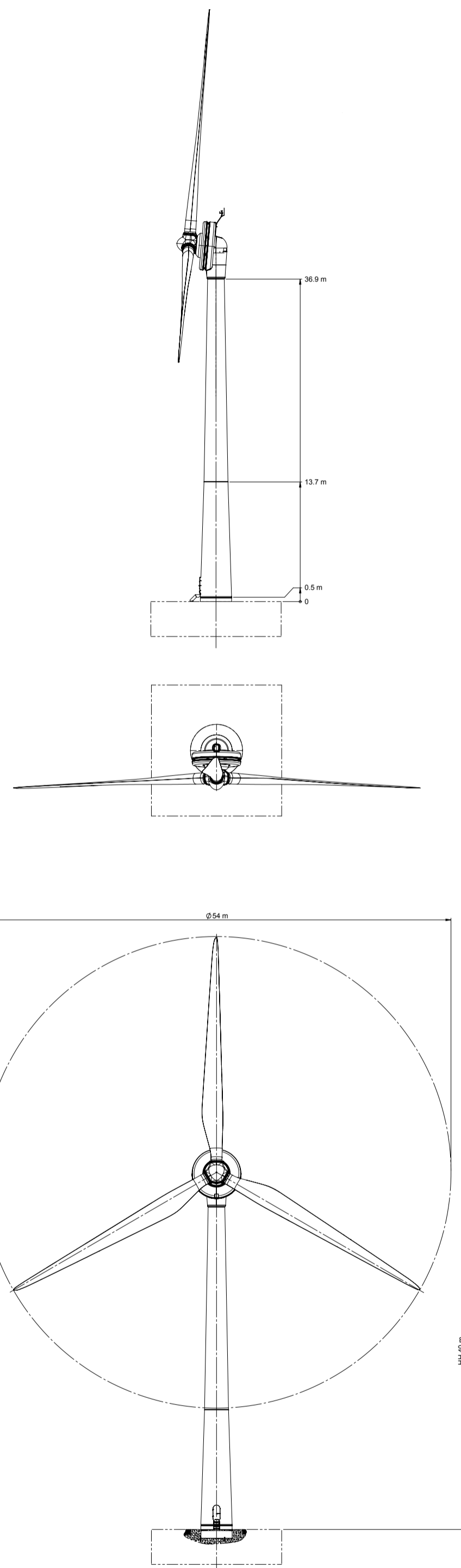

Turbine Plan Details

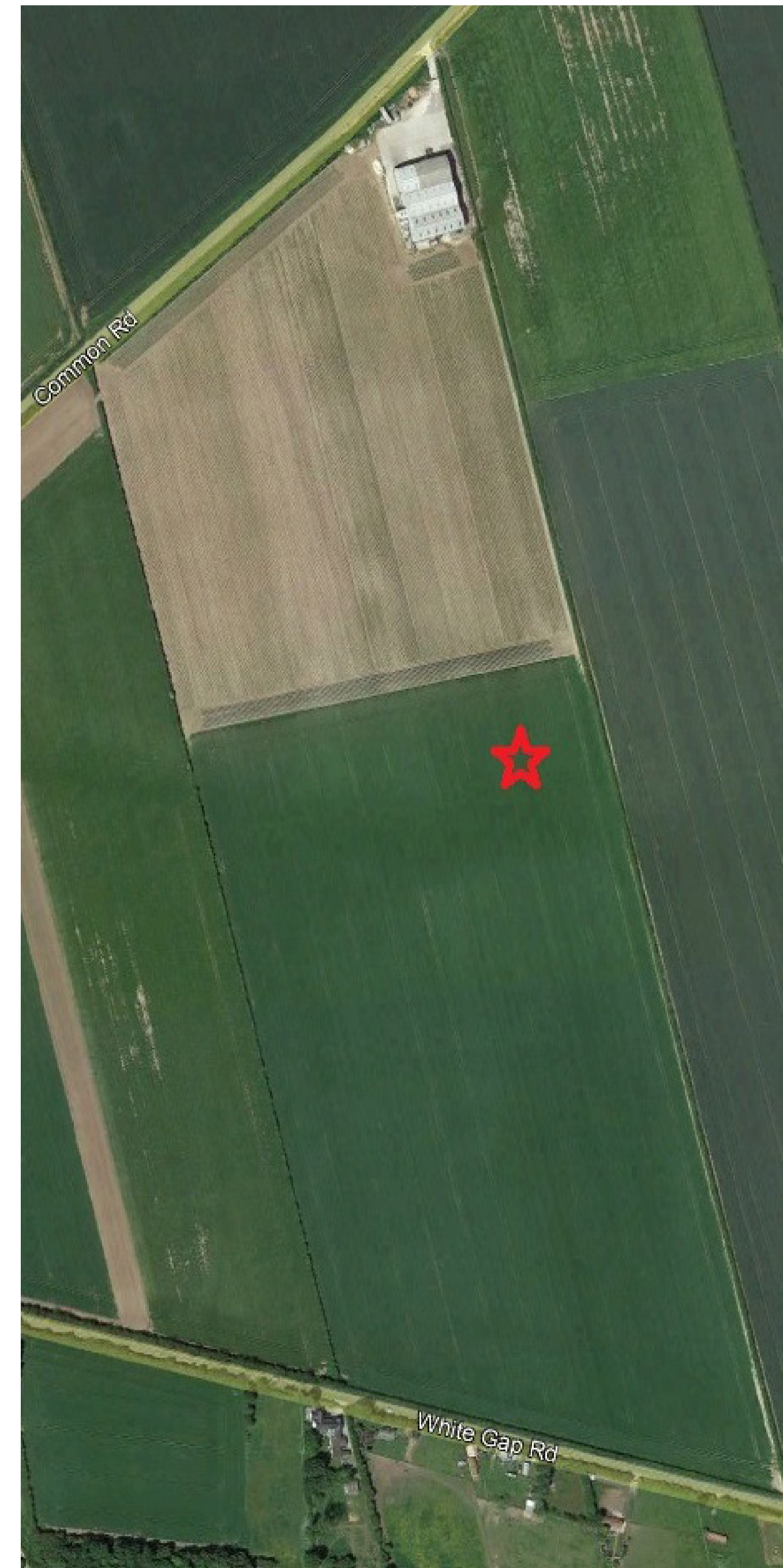

Site Location Plan

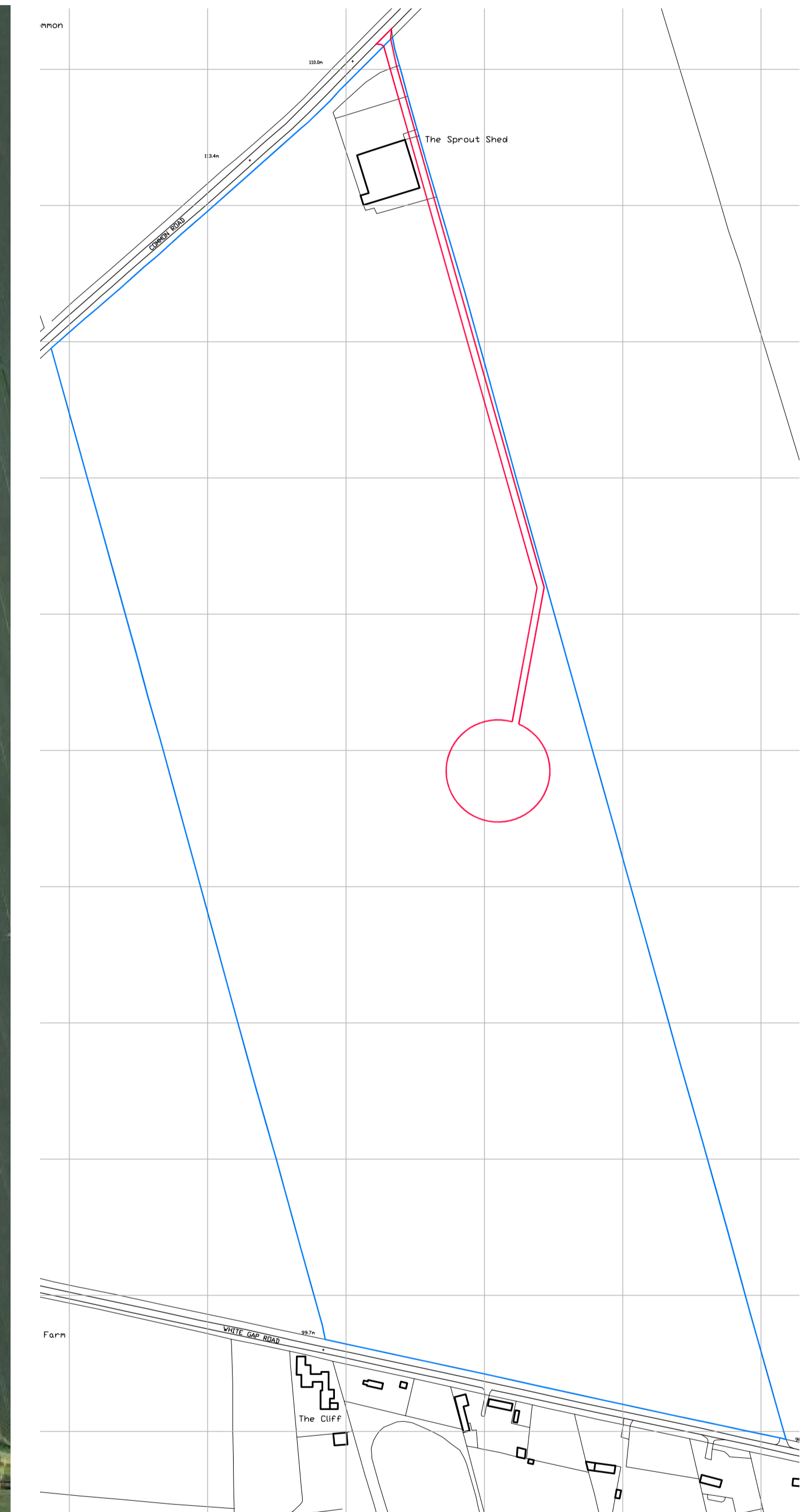

Site Location

PUBLIC CONSULTATION

Proposed Wind Turbine on land at White Gap Road, Rowley, Little Weighton, East Riding of Yorkshire

LANDSCAPE PHOTOMONTAGE

An assessment of the landscape and visual impact has been undertaken to ensure the proposed wind turbine can be accommodated in the landscape. The photomontages (right) demonstrates viewpoints towards the proposed turbine after installation.

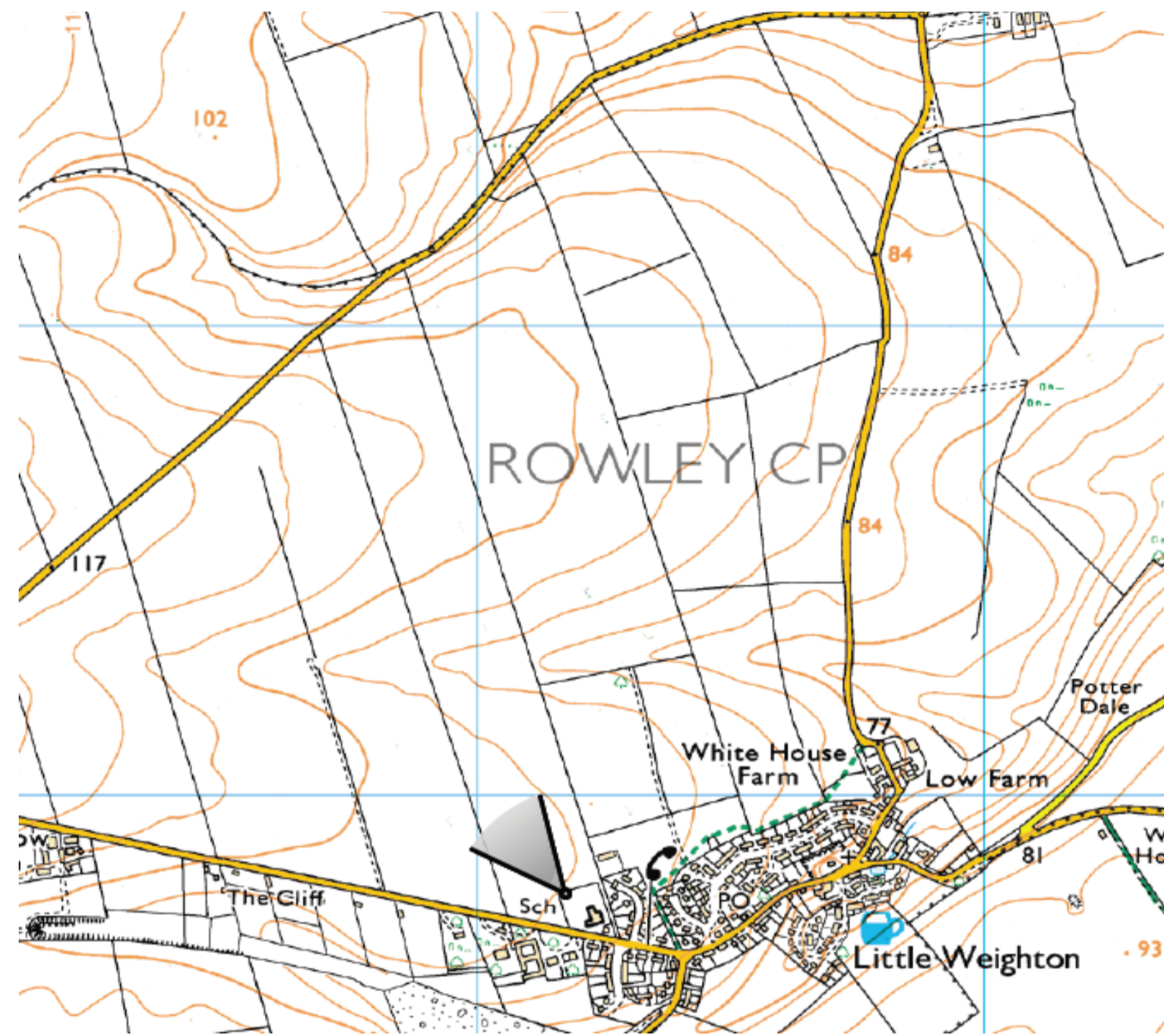

Viewpoint map for image to right.

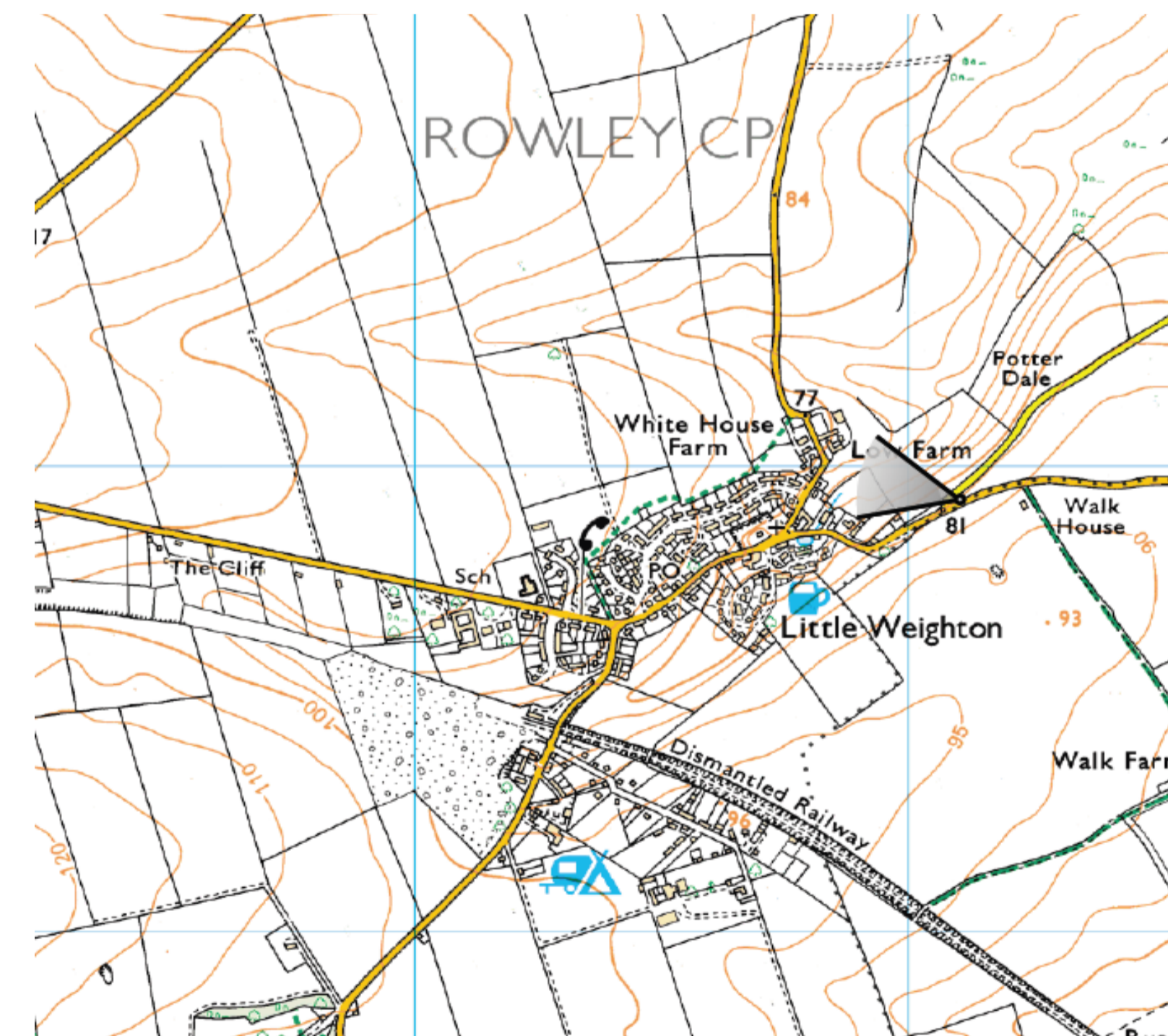

Viewpoint map for image to right.



PUBLIC CONSULTATION

Proposed Wind Turbine on land at White Gap Road, Rowley, Little Weighton, East Riding of Yorkshire

ACCESS ROUTE

The site plan (right) shows the proposed access route from Common Road. The existing junction will be upgraded, with a track measuring 517m and 4m wide constructed to the turbine pad.

A Transport Statement will be submitted in support of the application which details the transportation route for turbine installation; a number of physical enabling works have been suggested, such as: check foliage on Brick Dike Lane and White Gap Lane and trim as required and amend the existing access to the site from Common Road to meet the specification details provided by the manufacturer. A swept path analysis has also been undertaken to assess the suitability of the access junction

TECHNICAL CONSIDERATIONS

NOISE – A Noise Assessment has been undertaken within support of this application. On the basis of the predicted noise levels during both day and night time, it is evident that noise emissions at the nearest noise sensitive receptors due to the operation of the proposed turbine are below recommended limits.

SHADOW FLICKER – A Shadow Flicker Assessment has been undertaken and concluded that due to the distance of the turbine from and location of nearby dwellings, predominantly to the south, none of the dwellings will experience shadow flicker effects over the accepted guidance of 30 minutes per day per 30 hours per year.

ECOLOGY – An Ecological Impact Assessment is currently being undertaken

RADAR – Within the previous application an assessment on radar was undertaken, following these conclusions, the turbine height was reduced and upon submission there were no objections from Statutory Consultees.

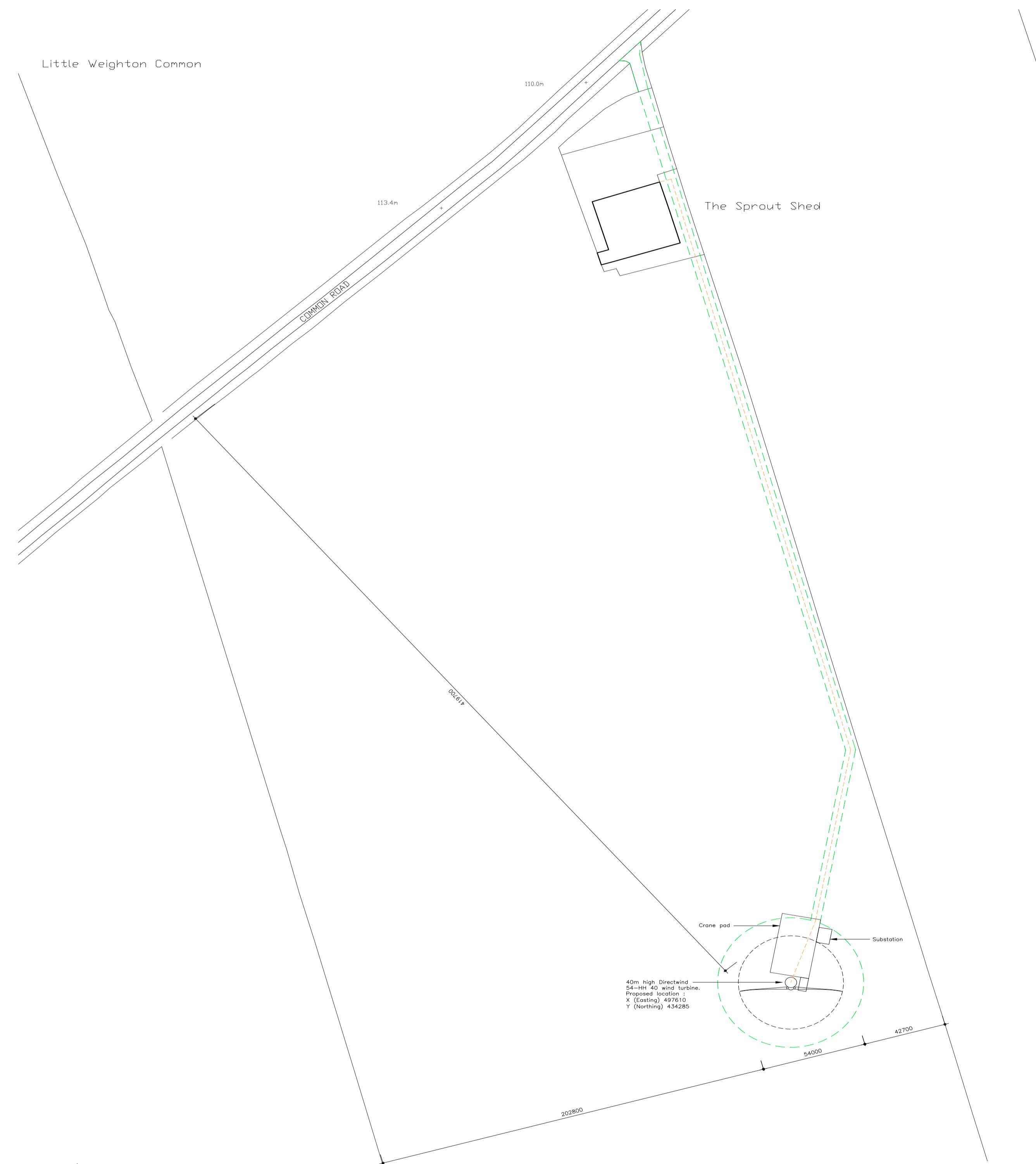

Proposed Site Plan showing access arrangements



Your views are important to us, so please take time to ask questions of the development team whilst also providing written feedback in the box provided. To view the consultation website, please scan the QR Code (right)

